



INVACARE® WALKERS AND ROLLATORS



Yes, you can.®

# Invacare® Walkers

With the Invacare Walker, providers, clinicians and consumers gain the stability they need at an economical price. Invacare Walkers offer a wide, deep frame with a large number of height adjustments and are offered in junior and adult sizes. The walker has a lower side brace for added stability and is stable, lightweight and easy to lift and maneuver. Walkers include PVC handgrips that provide comfort and long-lasting wear and anti-rattle silencers for quiet operation.

## Invacare® I-Class™ Paddle Walker Features

Composite lower side brace stiffens walker frame and adds stability

Folding mechanisms are easy to reach from a seated position

Lighter and easier to lift and maneuver

PVS handgrips wear longer and provide greater comfort

Walkers fold easily for transport or storage

**HCPCS Code\*:**

**E0135 Adult/Jr./Single**

**E0143 Wheeled Adult/Jr.**

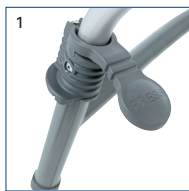

1. Dual-Release Paddle button



6291-A: Dual-Release Paddle Adult Walker



6291-5F: Dual-Release Adult Paddle Walker with 5" Wheels

The **Invacare® Heavy-Duty Dual-Release Paddle Walker** is strong, stable and simple to use, designed to help individuals to walk with confidence and ease. This walker also is compatible with Invacare leg accessories.

**HCPCS Code\*: E0148**



1. Dual Release Paddle button (model 6291-HDA)



6291-HDA: Heavy-Duty Dual-Release Adult Walker

## Walker Specifications



Model #	Width Inside Hand Grips	Width Inside Base Legs	Depth Opened At Base	Depth Folded	Height Adjustment	Product Weight	Weight Capacity
6291-A	17"	21.5"	17.5"	4"	30.375"-37.375"	5 lb. 5 oz.	300 lb.
6291-1	17"	21.5"	17.5"	4"	30.375"-37.375"	5 lb. 5 oz.	300 lb.
6291-JR	17"	20.5"	16.5"	4"	25.375"-32.375"	5 lb. 1 oz.	300 lb.
6291-5F**	17"	21.5"	17.5"	4.5"	33"-39"	5 lb. 6 oz.	300 lb.
6291-JR5F**	17"	20.25"	16.5"	4.5"	28"-34"	5 lb. 6 oz.	300 lb.
6291-HDA	20"	24"	17.5"	4"	30.375"-37.375"	6 lb. 11 oz.	500 lb.



Model #	Patient Height Range*	Units Per Carton	Limited Warranty
6291-A	5'3"-6'4"	4	5 Years
6291-1	5'3"-6'4"	1	5 Years
6291-JR	4'4"-5'7"	4	5 Years
6291-5F**	5'6"-6'6"	4	5 Years
6291-JR5F**	4'4"-5'6"	4	5 Years
6291-HDA	5'3"-6'4"	2	5 Years

\* All patient height ranges are approximate. Each individual should always consult with his/her physician or therapist to determine proper adjustment and usage.

\*\* With 13" rear leg extensions.

"F" designation in Model no. 3" or 5" fixed wheels with glide tips.

## Accessory Specifications



Model #	Patient Height Range Adult min. – max.	Patient Height Range Junior min. – max.	Limited Warranty
Fixed-wheel			
6270	31" – 37"	26" – 32"	5 Years
3" single fixed-wheels w/rear glide tips			
6271	33" – 39"	28" – 33"	5 Years
5" single fixed-wheels w/rear glide tips			



1. **Platform Attachment**

Model # G6027

Compatible with all walkers except model # 6291-HDA walker



1. **Glide Tips - 24**

Model # 6280

Packaged 24 per carton

Durable construction for long wear

**Glide Tips - 10**

Model # 1130781

Packaged 10 per carton

Durable construction for long wear

**Glide Tips - Single**

Model # 1040656

Packaged individually (1 each)

Durable construction for long wear

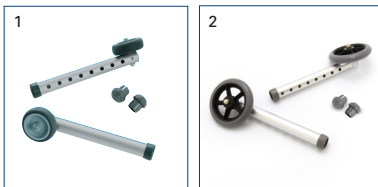

1. **3" Single Fixed-Wheel Attachments with Rear Glide Tips**

Model # 6270\*\*

2. **5" Single Fixed Wheel Attachments with Rear Glide Tips**

Model # 6271\*\*

Use 13" rear leg extensions for maximum adjustability

# Invacare® Rollator

## 66550 Bariatric Rollator Features

- Model # 66550
- 500 lb. weight capacity
- Wide, deep frame
- Flip-up padded seat
- Removable padded backrest
- Folds for ease of storage and transport
- Large 8" wheels for improved mobility over rougher terrain

- Height adjustable loop handbrakes with foam handgrips
- Durable steel construction
- Pouch included



**HCPCS Code\*: E0149**



1. Bariatric size

NOTE: Rollators are not intended to be used as wheelchairs.



Model #	Overall Dimensions	Dimension Inside Hand Grips	Seat Dimensions	Seat-to-Floor-Height	Caster Dimensions	Product Weight	Weight Capacity
66550	27" W 29.5" D	22"	18" W 14" D	22"	7.5"	26 lb.	500 lb.



	Patient Height Range	Units Per Carton	Limited Warranty
66550	N/A	1	5 Years Brakes 1 Year Components**

\*All references to HCPCS codes: Providers are responsible for determining the appropriate billing codes when submitting claims to the Medicare program, and should consult an attorney or other advisor to discuss specific situations in further details.

\*\*Excluding tires and wheels  
NOTE: Rollators are not intended to be used as wheelchairs

**Invacare Corporation**

[www.pro.invacare.com](http://www.pro.invacare.com)

**USA**

One Invacare Way  
Elyria, Ohio  
44035-4190  
(800) 333-6900

**Canada**

570 Matheson Blvd. E.,  
Unit 8  
Mississauga, Ontario  
L4Z 4G4 Canada  
(800) 668-5324

©2022

Invacare Corporation.

All rights reserved.

Trademarks are identified

by the symbols ™ and

®. All trademarks are

owned by or licensed

to Invacare Corporation

unless otherwise noted.

Specifications are subject

to change without

notification.

Form No. 19-074

Rev. 3/22

220227



**Yes, you can.®**